

D-Link®

Amazon Alexa

mydlink Smart Camera Setup Guide



1. Show your camera feed.

"Alexa, show <camera name>."

2. Hide your camera feed.

"Alexa, hide <camera name>."

3. Show your last recording.

"Alexa, show me the last event
on <camera name>."

Note: The screenshots may be different depending on your mobile device's OS version. The following steps show the iOS interface. If you are using an Android device, the appearance may be different from that of the screenshots, but the process is the same.

1 Tap on the Amazon Alexa app's home screen, then on **Skills & Games**.

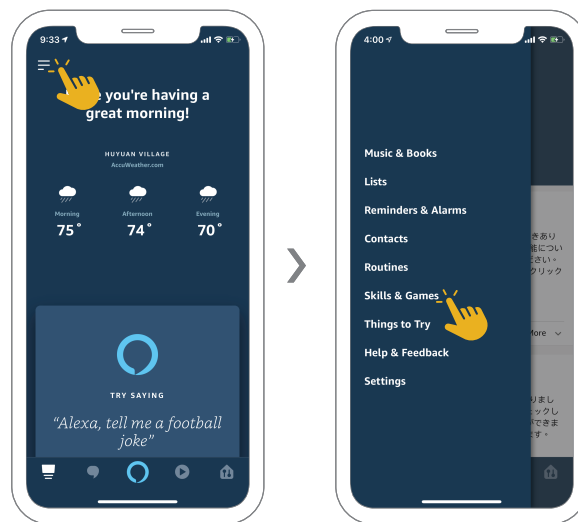

2 Search for "**mydlink Smart**". Tap on the result.

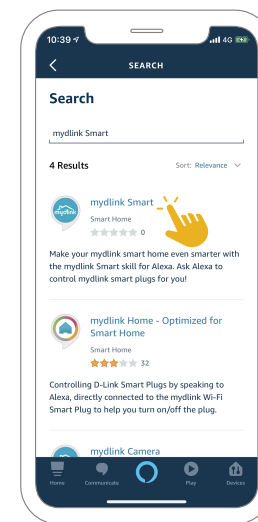

3 Tap **ENABLE TO USE**. Sign in with your mydlink account.

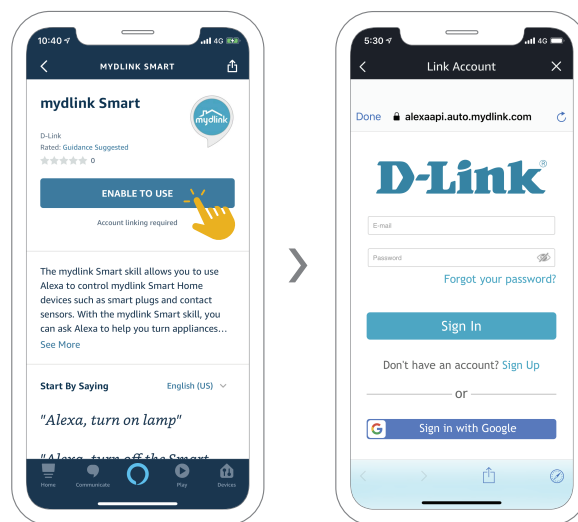

4 Tap then tap **DISCOVER DEVICES** and follow the on-screen instructions to complete the setup.

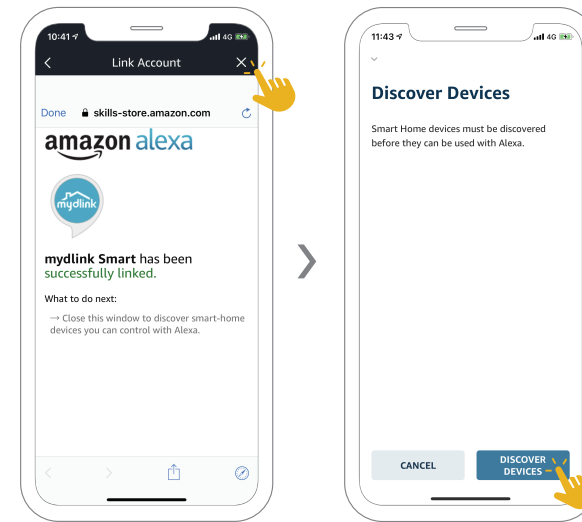



The Google Assistant mydlink Smart Camera Setup Guide



1. Show your camera feed.

OK Google, show <camera name>.

2. Stop your camera feed.

OK Google, stop <camera name>.

3. Disable privacy mode.

OK Google, turn on <camera name>.

Note: The screenshots may be different depending on your mobile device's OS version. The following steps show the iOS interface. If you are using an Android device, the appearance may be different from that of the screenshots, but the process is the same.

1 Tap and search for “mydlink Smart”. Tap on the result.

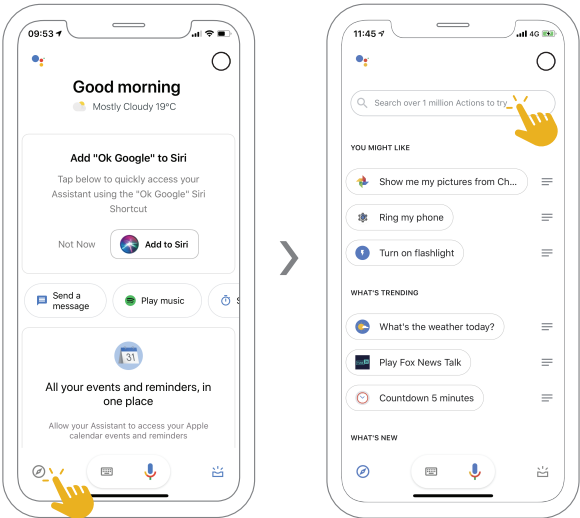

2 Tap **SET UP** then tap .

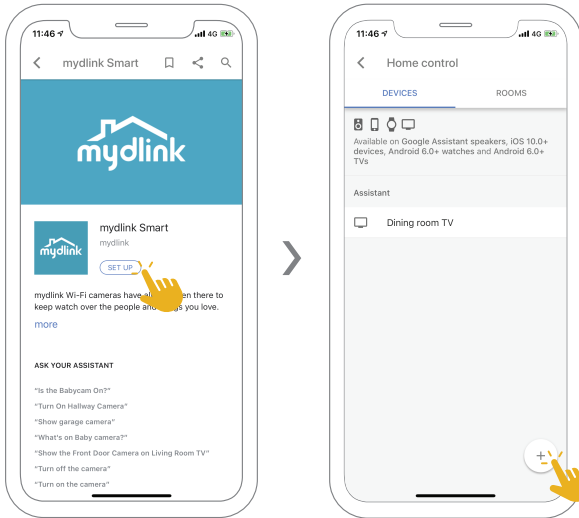

3 Search for “mydlink Smart”. Tap on the result. Sign in with your mydlink account. If you registered for mydlink using a Gmail account, wait while Google automatically links to the app.

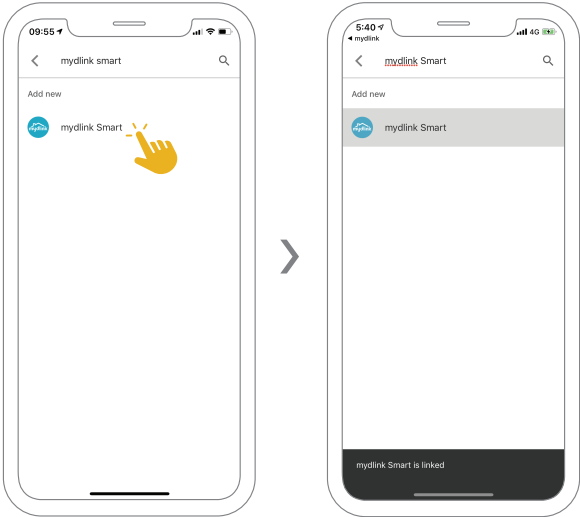

4 Tap to assign your device to a room. Tap **Done** to complete setup.

