

# D-Link®

## 8 PORT MULTI-GIGABIT DESKTOP SWITCH

# QUICK INSTALLATION GUIDE

INSTALLATIONSANLEITUNG

GUIDE D'INSTALLATION

GUÍA DE INSTALACIÓN

GUIDA DI INSTALLAZIONE

INSTALLATIEHANDLEIDING

INSTRUKCJA INSTALACJI

INSTALAČNÍ PŘÍRUČKA

TELEPÍTÉSI SEGÉDLET

INSTALLASJONSVEILEDNING

INSTALLATIONSVEJLEDNING

ASENNUSOPAS

INSTALLATIONSGUIDE

GUIA DE INSTALAÇÃO

ΟΔΗΓΟΣ ΓΡΗΓΟΡΗΣ ΕΓΚΑΤΑΣΤΑΣΗΣ

VODIČ ZA BRZU INSTALACIJU

KRATKA NAVODILA ZA UPORABO

GHID DE INSTALARE RAPIDĂ

РЪКОВОДСТВО ЗА БЪРЗА ИНСТАЛАЦИЯ

STRUČNÁ INŠTALAČNÁ PRÍRUČKA

КРАТКОЕ РУКОВОДСТВО ПО УСТАНОВКЕ

КОРОТКИЙ ПОСІБНИК ЗІ ВСТАНОВЛЕННЯ

ОРНАТУ БОЙЫНША ҚЫСҚАША НҰСҚАУЛЫҚ

快速安裝指南

PETUNJUK PEMASANGAN CEPAT

クイックインストールガイド

# PRODUCT SETUP

## HARDWARE INSTALLATION

### Desktop Mounting

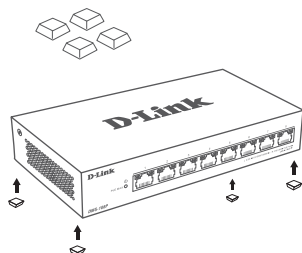

### Wall Mounting

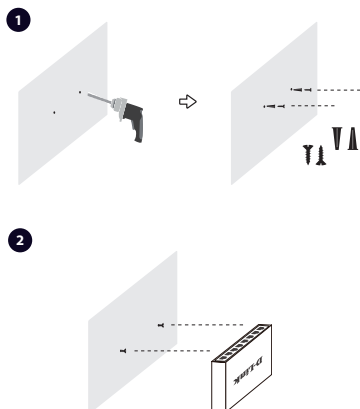

### Switch Grounding

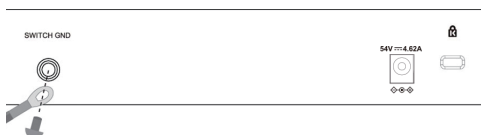

# PRODUCT SETUP

## SWITCH SET-UP

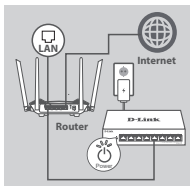

### Step 1

Plug the power adapter into a free wall socket, then plug the other end of the power adapter cable into the power port of the switch. The power LED will light up, confirming that the device is powered up successfully.

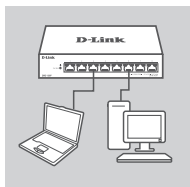

### Step 2

Use a LAN cable to connect your network device to one of the 8 ports on the switch.

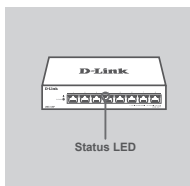

### Step 3

Check the Link/Act lights(LEDs) on the switch to verify a proper connection.

# PORT LED CONNECTION SPEED

## Link/ Act LED INDICATORS

Location	Color	Status	Description
LED Per 2.5G BASE-T Port (Port 1-8)	Green	Solid	2.5G Connection
		Blinking	Data transmission/Activity
	Amber	Solid	10/100/1000M Connection
		Blinking	Data transmission/Activity
	Off	Light off	No link

# TROUBLESHOOTING

## SETUP AND CONFIGURATION PROBLEMS

### 1. WHAT TO DO IF THE POWER LED IS NOT LIT UP?

Check if the power adapter is properly connected to a wall socket and the back of the switch.

### 2. WHAT TO DO IF A CONNECTED DEVICE IS NOT DETECTED?

First check if the Port LED is flashing. If the Port LED is not illuminated, try connecting the device using a different LAN cable.

## TECHNICAL SUPPORT



<http://www.dlink.com/support>